

For protection of Electronic Telephone Systems, PBX's, KSU's and Key Systems .

FEATURES & BENEFITS

- UL 497 Listed for primary protection
- Utilizes industry standard 5-pin protector modules
- 110 IDC termination input and output
- High-impact, fire retardant housing
- Units can be cascaded to provide for expansion
- Compact, lightweight design
- AQL Incoming Inspection Process
- ISO 9001:2000 registered facility
- Operating Temperature: -13°F to 149°F (-25°C to 65°C)

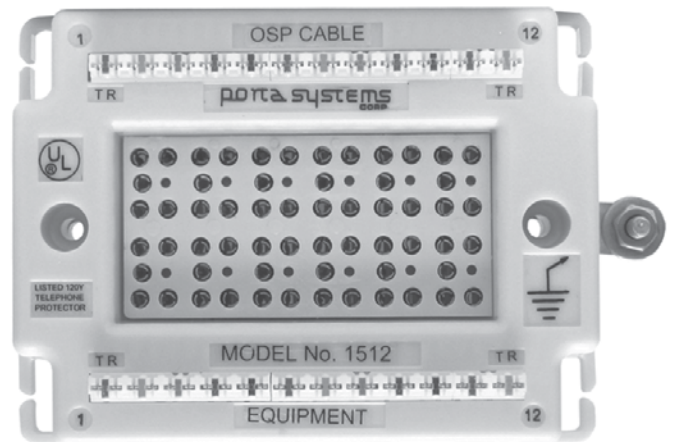

ORDERING INFORMATION

Model#	Pair Count	Input	Output	Modules	Module Model#
1512	12	110	110	None	NA
1512GT	12	110	110	230V Gas Tube	175BCXN-230
1512SS240	12	110	110	240V Solid State	115SCN-240
1512SS75	12	110	110	75V Solid State	115SCN-75
1512D230	12	110	110	230V Delta	195BCDXN-230
1512D75	12	110	110	75V Delta	195BCDXN-75

BUILDING ENTRANCE PROTECTOR



110 Termination

MECHANICAL SPECIFICATIONS FOR 1512 BUILDING ENTRANCE TERMINAL:

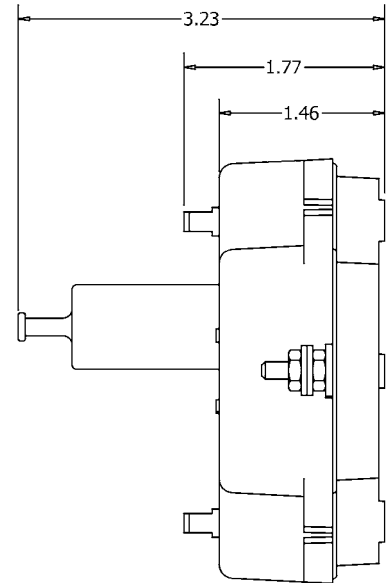
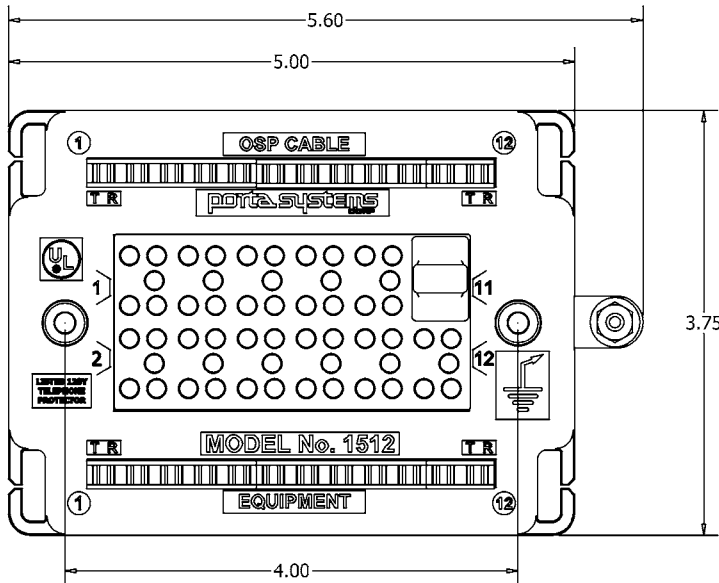

Pair Count	Dimensions (height x width x depth)	Weight (approx.)*
12 PAIR	3.75" x 5.6" x 3.3" (9.5 cm x 14.2 cm x 8.2 cm)	1 lbs.

* Weight - Add approx 0.5 oz per installed module.



For more information contact:
 6851 Jericho Turnpike, Suite 170
 Syosset, NY 11791 USA
 Tel. 1-516-364-9300 : Fx. 1.516.682.4636
 sales@portasystems.com (Americas)
 sales@portasystems.co.uk (Europe)